

Architect Magazine

'Spaces Without Drama' at the Graham Foundation

The show aims to explore the connection between architectural depictions and theater design.

By Katharine Keane

February 14, 2017



Stefano Graziani. Baukuh with Yellow Office and Stefano Graziani, "Model at Palazzo Reale," Milan, 2012.

The Graham Foundation for Advanced Studies in the Fine Arts, in Chicago, recently unveiled its newest exhibit. “Spaces Without Drama or Surface is an Illusion, But So is Depth,” exploring the relationship between architectural representation and “scenography and theatrical set design” according to the show description.

Inspired by Italian architect Aldo Rossi’s *Teatrino Scientifico* (Little Scientific Theater) model from 1978, curators Ruth Estévez and Wonne Ickx, with Mexico City–based initiative LIGA, which promotes Latin American architecture through exhibition, challenged architects, artists, and one dramaturg to explore the connection between architectural collage or depictions and theatrical scenery. “Participants were asked to use the lens of the traditional theatrical

Spaces without drama or surface is an illusion, but so is depth | February 16–July 1, 2017

Keane, Katharine. “‘Spaces Without Drama’ at the Graham Foundation,” *Architect Magazine*, February 14, 2017.

http://www.architectmagazine.com/design/culture/spaces-without-drama-at-the-graham-foundation_o

apparatus to explore the complex interaction between pictorial representation and three-dimensional composition,” Estévez and Ickx tell ARCHITECT.



Courtesy of the Fondazione Rossi. Aldo Rossi, "Teatrino Scientifico, Scena con Cabine," 1978.

Of the 23 exhibitors, 18 produced new work for the show using mediums such as photography, drawing, painting, 3D modeling, and collage.

The exhibition opens Feb. 16 and will be on display until July 1.

Featured designers include: architecture firms Emilio Ambasz, Baukuh, Gerardo Caballero, Fala Atelier, Marcelo Ferraz of Brasil Arquitetura, Sam Jacob Studio, Johnston Marklee, Monadnock, MOS Architects, Norman Kelley, OFFICE Kersten Geers David Van Severen, Cecilia Puga of Estudio Palma, Aldo Rossi, Taller de Arquitectura Mauricio Rocha + Gabriela Carrillo, Pezo Von Ellrichshausen; artists Pablo Bronstein, William Leavitt, Silke Otto-Knapp, Gabriel Sierra, Batia Suter; and dramaturg Jorge Palinhos.

Spaces without drama or surface is an illusion, but so is depth | February 16–July 1, 2017

Keane, Katharine. “‘Spaces Without Drama’ at the Graham Foundation,” *Architect Magazine*, February 14, 2017.

http://www.architectmagazine.com/design/culture/spaces-without-drama-at-the-graham-foundation_o

GF



Courtesy of MOS.MOS, "Rock 1," 2015.

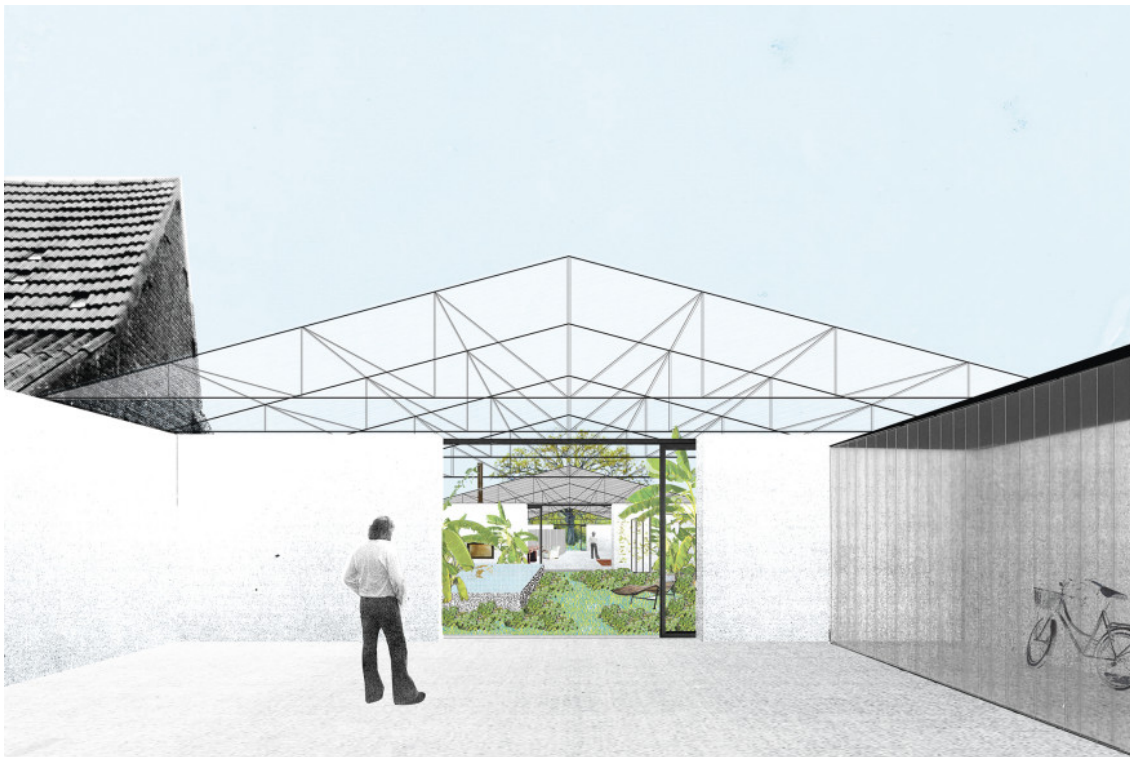

Courtesy of OFFICE KGDVS.OFFICE Kersten Geers David Van Severen, "Weekend House," collage, 2013.

Spaces without drama or surface is an illusion, but so is depth | February 16–July 1, 2017

Keane, Katharine. "'Spaces Without Drama' at the Graham Foundation," *Architect Magazine*, February 14, 2017.

http://www.architectmagazine.com/design/culture/spaces-without-drama-at-the-graham-foundation_o